

MSE 10/350-500 1...10 V

Direct current dimmable electronic drivers
Alimentatori elettronici regolabili in corrente continua

Made in Italy 

1...10 V **constant CURRENT**

110  SELV 60V

RIPPLE FREE

AM DIMMING
DIM-TO-WARM



2kV DIFF. 2kV COMM. **ACTIVE PFC** **SAFETY PROTECTIONS**

Rated Voltage
Tensione Nominale
220 ÷ 240 V

Frequency
Frequenza
50-60 Hz

AC Operation range
Tensione di utilizzo AC
198 ÷ 264 V

Power
Potenza
5 ÷ 10 W

Output current ripple
≤ 3% ⁽¹⁾

Standards compliance
EN 55015
EN 60335-1
EN 61000-3-2
EN 61000-3-3
EN 61347-1
EN 61347-2-13
EN 61547
EN 62384
VDE 0710 T14

Max. pcs for CB B16A
(see page info17)
50 pcs

In rush current
5A 50µsec

Article Articolo	Code Codice	P out W	V out DC ⁽¹⁾	I out DC	Jumper JP1	U out V	ta °C	tc °C	λ max. Power Factor	η max. Efficiency ⁽¹⁾
MSE 10/350-500 1-10V	127624	7	15...20	350 mA cost.	-	28	-25...+50	80	0,98	> 79
		10	15...20	500 mA cost.	ON (default)					

⁽¹⁾ Referred to V_{in} = 230 V, 100% load - Riferito a V_{in} = 230 V, carico 100%

BUILT-IN SCREW FIXING Weight - Peso: gr. 63 / 2,2 oz.
Pcs - Pezzi -

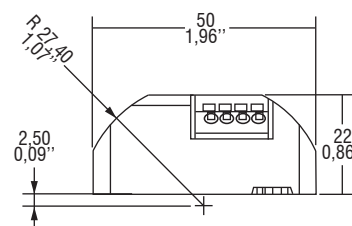
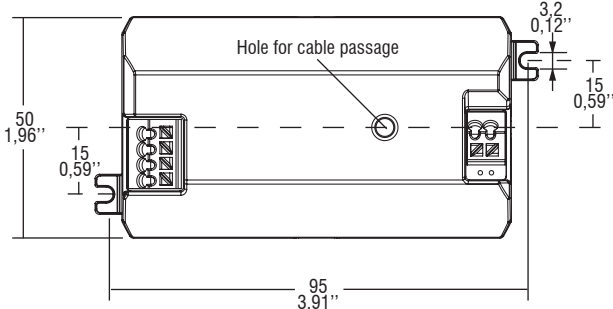
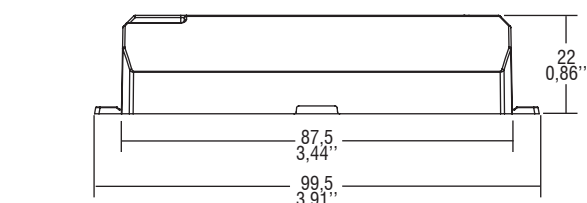

Wiring diagram - Schema di collegamento

(Max. LED distance on page info8 - Massima distanza LED a pagina info8)

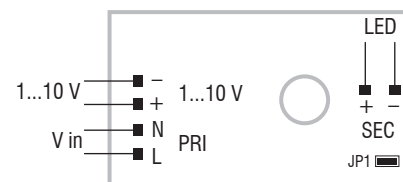

Features

- Light regulation 1-100% by means of 1-10V (I=1mA).
- **Dimming method is AMPLITUDE.**
- Possibility to choose the output current through specific JUMPER.
- Driver for built-in use.
- It can be used for lighting equipment in protection class I and II.
- Push-wire connections (wire cross-section up to 0,5 - 1,5 mm² / AWG20 - AWG15).
- Input and output terminal blocks on opposite sides.
- Single terminal block at the primary and secondary circuit (wire cross-section up to 1,5 mm² / AWG15).
- Driver can be secured with slot for screws.
- Ultra compact size.
- Protections:
 - against overheating and short circuits;
 - against mains voltage spikes;
 - against overloads.
- Current regulation ±5% including temperature variations.

Caratteristiche

- Regolazione della luminosità 1-100 % mediante funzione 1-10 V (I=1 mA).
- **La dimmerazione è in ampiezza.**
- Possibilità di scegliere la corrente d'uscita tramite JUMPER dedicato.
- Alimentatore da incorporare.
- Utilizzabile per apparecchi di illuminazione in classe di protezione I e II.
- Morsetti ad innesto rapido (sezione cavo fino a 0,5 - 1,5 mm² / AWG20 - AWG15).
- Morsetti di entrata e uscita contrapposti.
- Singolo morsetto su primario e secondario (sezione morsetto 1,5 mm² / AWG15).
- Fissaggio dell'alimentatore tramite asole per viti.
- Dimensioni molto ridotte e compatte.
- Protezioni:
 - termica e cortocircuito;
 - contro le extra-tensioni di rete;
 - contro i sovraccarichi.
- Corrente regolata ±5% incluse variazioni di temperatura.

3.1.1

Dimmable multipower DIP-SWITCH drivers - Compact case 1-10V & PUSH
Alimentatori multipotenza regolabili con DIP-SWITCH - Formato compatto - 1-10V & PUSH

7 YEARS WARRANTY
3% FAILURE RATE

10 YEARS WARRANTY
5% FAILURE RATE

PRODUCER'S LIABILITY
TCI LED

POWERED WITH FLEETING
WARRANTY TO THE
10 ACCORDING TO THE
CONVENTIONS