

Direct current electronic drivers
Alimentatori elettronici in corrente continua

Made in Italy 

constant CURRENT constant VOLTAGE

IS 15885
(Part 2 / Sec 13)

R - 41049751

DAMP LOCATION 

UL-CLASS2
CSA-LVLE 

05 

KEMA EUR 

PS JET 

CCC 

100 M M 

EL 

SELV 60V 

RIPPLE FREE 



1-2kV DIFF. 2kV COMM. 

Rated Voltage
Tensione Nominale
100 ÷ 127 V ⁽³⁾
100 ÷ 240 V

Frequency
Frequenza
50-60 Hz

AC Operation range
Tensione di utilizzo AC
90 ÷ 264 V

DC Operation range
Tensione di utilizzo DC
(see page info15)
176 ÷ 264 V

Power
Potenza
0 ÷ 8 W

Output current ripple
≤ 3% ⁽¹⁾

Standards compliance
CSA C22.2 no. 223 ⁽³⁾
EN 50172 (VDE 0108)
EN 55015
EN 61000-3-2
EN 61000-3-3
EN 61347-1
EN 61347-2-13
EN 61547
EN 62384
UL 1310 ⁽³⁾
UL 8750 ⁽³⁾
VDE 0710-T14

Max. pcs for CB B16A
(see page info17)
50 pcs

In rush current
20A 170µsec

| Article Articolo | Code Codice | P out W | V out DC | I out DC | U out V | ta °C | tc °C | λ max. Power Factor | η max. Efficiency ⁽¹⁾ |
|--|----------------|--------------------|-------------|--------------|------------|------------------------------|----------|---------------------------|-------------------------------------|
| DC 3W 125mA STM/U | 122814 | 3 | 2...23 | 125 mA cost. | 24 | -25...+60 | 75 | 0,6 C | 70 |
| DC 6W 150mA STM/U ⁽³⁾ | 122799 | 6 | 2...40 | 150 mA cost. | 44 | -25...+55 | 75 | 0,6 C | 70 |
| DC 6W 250mA STM/U ⁽³⁾⁽⁴⁾⁽⁵⁾ | 122812 | 6 | 2...23 | 250 mA cost. | 25 | -25...+60 | 80 | 0,6 C | 73 |
| DC 8W 350mA STM/U ⁽³⁾⁽⁴⁾⁽⁵⁾ | 122811 | 6/8 ⁽²⁾ | 2...23 | 350 mA cost. | 25 | -25...+55 ⁽²⁾ /60 | 80 | 0,6 C | 77 |
| DC 6W 500mA STM/U ⁽³⁾⁽⁵⁾ | 122813 | 6 | 2...11,5 | 500 mA cost. | 13 | -25...+55 | 75 | 0,6 C | 73 |
| DC 6W 700mA STM/U ⁽³⁾⁽⁵⁾ | 122815 | 6 | 2...8,5 | 700 mA cost. | 13 | -25...+50 | 70 | 0,6 C | 73 |

⁽¹⁾ Referred to V_{in} = 230 V, 100% load - Riferito a V_{in} = 230 V, carico 100%

⁽⁶⁾ 122814BIS - 122799BIS - 122812BIS - 122811BIS - 122813BIS - 122815BIS:
order codes for BIS marked products - codici di ordine per i prodotti marchiati BIS

BUILT-IN SCREW FIXING 

Weight - Peso: gr. 35 / 1,23 oz.
Pcs - Pezzi 90

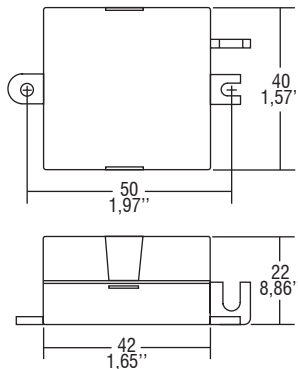

Wiring diagram - Schema di collegamento

(Max. LED distance on page info8 - Massima distanza LED a pagina info8)

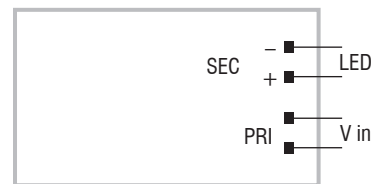

Features

- Driver for built-in use.
- Input and output terminal blocks on the same side.
- Single terminal at the primary and secondary circuit (wire cross-section up to 2,5 mm² / AWG13).
- Ultra compact size.
- It can be used for lighting equipment in protection class I and II.
- Driver can be secured with slot for screws.
- Protections:
 - against overheating and short circuits;
 - against mains voltage spikes;
 - against overloads.
- Current regulation -8 % + 5 % including temperature variations.

Caratteristiche

- Alimentatore da incorporare.
- Morsetti di entrata e uscita sullo stesso lato.
- Singolo morsetto su primario e secondario (sezione cavo fino a 2,5 mm² / AWG13).
- Dimensioni molto ridotte e compatte.
- Utilizzabile per apparecchi di illuminazione in classe di protezione I e II.
- Fissaggio dell'alimentatore tramite asole per viti.
- Protezioni:
 - termica e cortocircuito;
 - contro le extra-tensioni di rete;
 - contro i sovraccarichi.
- Corrente regolata -8 % + 5 % incluse variazioni di temperatura.

7 YEARS WARRANTY 3% FAILURE RATE
10 YEARS WARRANTY 5% FAILURE RATE

PRODUCER'S LIABILITY TCl
POWERED WITH FLEECING WARRANTY TO TCl ACCORDING TO THE CONTRACTOR'S CONDITIONS

1.1
Single current drivers - Without PFC
Alimentatori corrente singola - Senza PFC