

## Trasformatori toroidali extrapiatti Extra-flat toroidal transformers

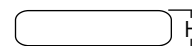
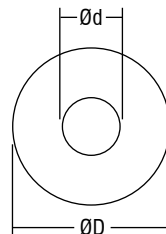

Articolo Article	Codice Code	Potenza Power VA	Tensione Voltage (in/out) V	Protezione Protection	Dimensioni Dimensions			Peso Weight gr.	Omologazioni Approvals	Confezioni Box
					Ød	ØD	H			
TO 35 A	149099	35	230/12	FEV*	60	110	25	700		5
TO 50 A	147585	50	230/12	FEV*	85	125	31	950		5
TO 50 PS	147955A	50	230/12	TA	30	93	25	800		5
TO 50 PDAS	145580A	50	230/12/9	TA	30	93	25	800		5
TO 50 PI	147430	50	230/12	FEV*	25	110	22	900		5
TO 50 PV	147570	50	230/12	TA	25	110	22	900		5
TO 50 PDAV	147580	50	230/12/9	TA	25	110	22	950		5
TO 60 PI	147590	60	230/12	FEV*	23	113	23	980		5
TO 60 PV	147600	60	230/12	TA	23	113	23	980		5
TO 60 PDAV	147610	60	230/12/9	TA	23	115	25	1030		5
TO 80 PV	148163A	80	240/12	TA	40	115	27	1230		5
TO 100 PI	147620	100	230/12	FEV*	36	128	28	1300		5
TO 100 PV	147630	100	230/12	TA	36	128	28	1300		5
TO 120 PV	148392B	120	230/12	TA	35	130	30	1400		5
TO 150 PI.VF	147240	150	230/12	FEV*	45	130	33	1800		5
TO 150 PV	147660	150	230/12	TA	45	130	33	1800	Ⓜ	5
TO 150 PV	147662	150	230/12	TA	35	135	35	1800		5
TO 160 PV	147661B	160	230/12	TA	44	132	35	1900		5
TO 200 PV	147095	200	230/12	TA	40	138	33	2000		5
TO 200 PV	148335	200	230/12	TA	43	138	35	2500		5
TO 250 PK	146850	250	230/12	TA	35	135	37	2100		5
TO 250 PV	147569R	250	230/12	TA	45	143	33	2400		5
TO 300 PK	148358	300	230/12	TA	50	200	32	3000		5
TO 350 PV	148362	350	230/12	TA	37	180	35	3800		5
TO 350 PK	148362A	350	120/12	TA	37	180	35	3800		5
TO 400 PV	148350A	400	230/12	TA	37	180	35	3800		5
TO 450 PV	149375	450	230/12	TA	38	180	35	3800		5
TO 550 PV	149425	550	230/12	TA	36	190	39	4200		5

\* FEV fusibile esterno da montare su primario (attenersi al valore del fusibile indicato sull'etichetta del trasformatore).

Add the FEV protection, externally assembled (see fuse value on the transformer label).

**Norme di riferimento**  
Reference Norms:  
EN 61558-1  
EN 61558-2-6

**Tensione Voltage**  
230 V - 12 V  
230 V - 12/9 V  
240 V - 12 V  
120 V - 12 V

**Frequenza Frequency**  
0/50...60 Hz

**Potenza Power**  
35 ÷ 550 VA

- Trasformatori da incorporare IP00.
- Classe termica di isolamento B = 120°C.
- A richiesta disponibile versione 240 o 120 V.**
- A richiesta disponibile versione 24 V o altre.**

- IP00 transformers for integrated installation.
- Thermal insulation class B = 120°C.
- 240 or 120 V version available upon request.**
- 24 V version available upon request.**

0,5 - 1,5 □

