

Trasformatori toroidali extrapiatti Extra-flat toroidal transformers

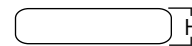
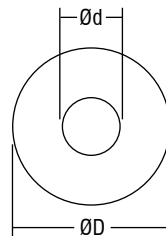

| Articolo Article | Codice Code | Potenza Power VA | Tensione Voltage (in/out) V | Protezione Protection | Dimensioni Dimensions | | | Peso Weight gr. | Omologazioni Approvals | Confezioni Box |
|---------------------|----------------|------------------------|-----------------------------------|--------------------------|--------------------------|-----|----|-----------------------|---------------------------|-------------------|
| | | | | | Ød | ØD | H | | | |
| TO 35 A | 149099 | 35 | 230/12 | FEV* | 60 | 110 | 25 | 700 | | 5 |
| TO 50 A | 147585 | 50 | 230/12 | FEV* | 85 | 125 | 31 | 950 | | 5 |
| TO 50 PS | 147955A | 50 | 230/12 | TA | 30 | 93 | 25 | 800 | | 5 |
| TO 50 PDAS | 145580A | 50 | 230/12/9 | TA | 30 | 93 | 25 | 800 | | 5 |
| TO 50 PI | 147430 | 50 | 230/12 | FEV* | 25 | 110 | 22 | 900 | | 5 |
| TO 50 PV | 147570 | 50 | 230/12 | TA | 25 | 110 | 22 | 900 | | 5 |
| TO 50 PDAV | 147580 | 50 | 230/12/9 | TA | 25 | 110 | 22 | 950 | | 5 |
| TO 60 PI | 147590 | 60 | 230/12 | FEV* | 23 | 113 | 23 | 980 | | 5 |
| TO 60 PV | 147600 | 60 | 230/12 | TA | 23 | 113 | 23 | 980 | | 5 |
| TO 60 PDAV | 147610 | 60 | 230/12/9 | TA | 23 | 115 | 25 | 1030 | | 5 |
| TO 80 PV | 148163A | 80 | 240/12 | TA | 40 | 115 | 27 | 1230 | | 5 |
| TO 100 PI | 147620 | 100 | 230/12 | FEV* | 36 | 128 | 28 | 1300 | | 5 |
| TO 100 PV | 147630 | 100 | 230/12 | TA | 36 | 128 | 28 | 1300 | | 5 |
| TO 120 PV | 148392B | 120 | 230/12 | TA | 35 | 130 | 30 | 1400 | | 5 |
| TO 150 PI.VF | 147240 | 150 | 230/12 | FEV* | 45 | 130 | 33 | 1800 | | 5 |
| TO 150 PV | 147660 | 150 | 230/12 | TA | 45 | 130 | 33 | 1800 | Ⓜ | 5 |
| TO 150 PV | 147662 | 150 | 230/12 | TA | 35 | 135 | 35 | 1800 | | 5 |
| TO 160 PV | 147661B | 160 | 230/12 | TA | 44 | 132 | 35 | 1900 | | 5 |
| TO 200 PV | 147095 | 200 | 230/12 | TA | 40 | 138 | 33 | 2000 | | 5 |
| TO 200 PV | 148335 | 200 | 230/12 | TA | 43 | 138 | 35 | 2500 | | 5 |
| TO 250 PK | 146850 | 250 | 230/12 | TA | 35 | 135 | 37 | 2100 | | 5 |
| TO 250 PV | 147569R | 250 | 230/12 | TA | 45 | 143 | 33 | 2400 | | 5 |
| TO 300 PK | 148358 | 300 | 230/12 | TA | 50 | 200 | 32 | 3000 | | 5 |
| TO 350 PV | 148362 | 350 | 230/12 | TA | 37 | 180 | 35 | 3800 | | 5 |
| TO 350 PK | 148362A | 350 | 120/12 | TA | 37 | 180 | 35 | 3800 | | 5 |
| TO 400 PV | 148350A | 400 | 230/12 | TA | 37 | 180 | 35 | 3800 | | 5 |
| TO 450 PV | 149375 | 450 | 230/12 | TA | 38 | 180 | 35 | 3800 | | 5 |
| TO 550 PV | 149425 | 550 | 230/12 | TA | 36 | 190 | 39 | 4200 | | 5 |

* FEV fusibile esterno da montare su primario (attenersi al valore del fusibile indicato sull'etichetta del trasformatore).

Add the FEV protection, externally assembled (see fuse value on the transformer label).

Norme di riferimento
Reference Norms:
EN 61558-1
EN 61558-2-6

Tensione Voltage
230 V - 12 V
230 V - 12/9 V
240 V - 12 V
120 V - 12 V

Frequenza Frequency
0/50...60 Hz

Potenza Power
35 ÷ 550 VA

- Trasformatori da incorporare IP00.
- Classe termica di isolamento B = 120°C.
- A richiesta disponibile versione 240 o 120 V.**
- A richiesta disponibile versione 24 V o altre.**

- IP00 transformers for integrated installation.
- Thermal insulation class B = 120°C.
- 240 or 120 V version available upon request.**
- 24 V version available upon request.**

0,5 - 1,5 □

