

## Trasformatori toroidali extrapiatti Extra-flat toroidal transformers

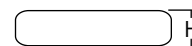
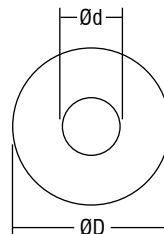

| Articolo<br>Article | Codice<br>Code | Potenza<br>Power<br>VA | Tensione<br>Voltage<br>(in/out) V | Protezione<br>Protection | Dimensioni<br>Dimensions |     |    | Peso<br>Weight<br>gr. | Omologazioni<br>Approvals | Confezioni<br>Box |
|---------------------|----------------|------------------------|-----------------------------------|--------------------------|--------------------------|-----|----|-----------------------|---------------------------|-------------------|
|                     |                |                        |                                   |                          | Ød                       | ØD  | H  |                       |                           |                   |
| TO 35 A             | 149099         | 35                     | 230/12                            | FEV*                     | 60                       | 110 | 25 | 700                   |                           | 5                 |
| TO 50 A             | 147585         | 50                     | 230/12                            | FEV*                     | 85                       | 125 | 31 | 950                   |                           | 5                 |
| TO 50 PS            | 147955A        | 50                     | 230/12                            | TA                       | 30                       | 93  | 25 | 800                   |                           | 5                 |
| TO 50 PDAS          | 145580A        | 50                     | 230/12/9                          | TA                       | 30                       | 93  | 25 | 800                   |                           | 5                 |
| TO 50 PI            | 147430         | 50                     | 230/12                            | FEV*                     | 25                       | 110 | 22 | 900                   |                           | 5                 |
| TO 50 PV            | 147570         | 50                     | 230/12                            | TA                       | 25                       | 110 | 22 | 900                   |                           | 5                 |
| TO 50 PDAV          | 147580         | 50                     | 230/12/9                          | TA                       | 25                       | 110 | 22 | 950                   |                           | 5                 |
| TO 60 PI            | 147590         | 60                     | 230/12                            | FEV*                     | 23                       | 113 | 23 | 980                   |                           | 5                 |
| TO 60 PV            | 147600         | 60                     | 230/12                            | TA                       | 23                       | 113 | 23 | 980                   |                           | 5                 |
| TO 60 PDAV          | 147610         | 60                     | 230/12/9                          | TA                       | 23                       | 115 | 25 | 1030                  |                           | 5                 |
| TO 80 PV            | 148163A        | 80                     | 240/12                            | TA                       | 40                       | 115 | 27 | 1230                  |                           | 5                 |
| TO 100 PI           | 147620         | 100                    | 230/12                            | FEV*                     | 36                       | 128 | 28 | 1300                  |                           | 5                 |
| TO 100 PV           | 147630         | 100                    | 230/12                            | TA                       | 36                       | 128 | 28 | 1300                  |                           | 5                 |
| TO 120 PV           | 148392B        | 120                    | 230/12                            | TA                       | 35                       | 130 | 30 | 1400                  |                           | 5                 |
| TO 150 PI.VF        | 147240         | 150                    | 230/12                            | FEV*                     | 45                       | 130 | 33 | 1800                  |                           | 5                 |
| TO 150 PV           | 147660         | 150                    | 230/12                            | TA                       | 45                       | 130 | 33 | 1800                  | Ⓜ                         | 5                 |
| TO 150 PV           | 147662         | 150                    | 230/12                            | TA                       | 35                       | 135 | 35 | 1800                  |                           | 5                 |
| TO 160 PV           | 147661B        | 160                    | 230/12                            | TA                       | 44                       | 132 | 35 | 1900                  |                           | 5                 |
| TO 200 PV           | 147095         | 200                    | 230/12                            | TA                       | 40                       | 138 | 33 | 2000                  |                           | 5                 |
| TO 200 PV           | 148335         | 200                    | 230/12                            | TA                       | 43                       | 138 | 35 | 2500                  |                           | 5                 |
| TO 250 PK           | 146850         | 250                    | 230/12                            | TA                       | 35                       | 135 | 37 | 2100                  |                           | 5                 |
| TO 250 PV           | 147569R        | 250                    | 230/12                            | TA                       | 45                       | 143 | 33 | 2400                  |                           | 5                 |
| TO 300 PK           | 148358         | 300                    | 230/12                            | TA                       | 50                       | 200 | 32 | 3000                  |                           | 5                 |
| TO 350 PV           | 148362         | 350                    | 230/12                            | TA                       | 37                       | 180 | 35 | 3800                  |                           | 5                 |
| TO 350 PK           | 148362A        | 350                    | 120/12                            | TA                       | 37                       | 180 | 35 | 3800                  |                           | 5                 |
| TO 400 PV           | 148350A        | 400                    | 230/12                            | TA                       | 37                       | 180 | 35 | 3800                  |                           | 5                 |
| TO 450 PV           | 149375         | 450                    | 230/12                            | TA                       | 38                       | 180 | 35 | 3800                  |                           | 5                 |
| TO 550 PV           | 149425         | 550                    | 230/12                            | TA                       | 36                       | 190 | 39 | 4200                  |                           | 5                 |

\* FEV fusibile esterno da montare su primario (attenersi al valore del fusibile indicato sull'etichetta del trasformatore).

Add the FEV protection, externally assembled (see fuse value on the transformer label).

**Norme di riferimento**  
Reference Norms:  
EN 61558-1  
EN 61558-2-6

**Tensione Voltage**  
230 V - 12 V  
230 V - 12/9 V  
240 V - 12 V  
120 V - 12 V

**Frequenza Frequency**  
0/50...60 Hz

**Potenza Power**  
35 ÷ 550 VA

- Trasformatori da incorporare IP00.
- Classe termica di isolamento B = 120°C.
- A richiesta disponibile versione 240 o 120 V.**
- A richiesta disponibile versione 24 V o altre.**

- IP00 transformers for integrated installation.
- Thermal insulation class B = 120°C.
- 240 or 120 V version available upon request.**
- 24 V version available upon request.**

0,5 - 1,5 □

