

Trasformatori toroidali extrapiatti Extra-flat toroidal transformers

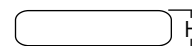
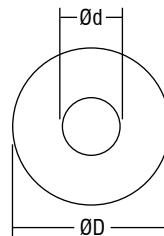

Articolo Article	Codice Code	Potenza Power VA	Tensione Voltage (in/out) V	Protezione Protection	Dimensioni Dimensions			Peso Weight gr.	Omologazioni Approvals	Confezioni Box
					Ød	ØD	H			
TO 35 A	149099	35	230/12	FEV*	60	110	25	700		5
TO 50 A	147585	50	230/12	FEV*	85	125	31	950		5
TO 50 PS	147955A	50	230/12	TA	30	93	25	800		5
TO 50 PDAS	145580A	50	230/12/9	TA	30	93	25	800		5
TO 50 PI	147430	50	230/12	FEV*	25	110	22	900		5
TO 50 PV	147570	50	230/12	TA	25	110	22	900		5
TO 50 PDAV	147580	50	230/12/9	TA	25	110	22	950		5
TO 60 PI	147590	60	230/12	FEV*	23	113	23	980		5
TO 60 PV	147600	60	230/12	TA	23	113	23	980		5
TO 60 PDAV	147610	60	230/12/9	TA	23	115	25	1030		5
TO 80 PV	148163A	80	240/12	TA	40	115	27	1230		5
TO 100 PI	147620	100	230/12	FEV*	36	128	28	1300		5
TO 100 PV	147630	100	230/12	TA	36	128	28	1300		5
TO 120 PV	148392B	120	230/12	TA	35	130	30	1400		5
TO 150 PI.VF	147240	150	230/12	FEV*	45	130	33	1800		5
TO 150 PV	147660	150	230/12	TA	45	130	33	1800	Ⓜ	5
TO 150 PV	147662	150	230/12	TA	35	135	35	1800		5
TO 160 PV	147661B	160	230/12	TA	44	132	35	1900		5
TO 200 PV	147095	200	230/12	TA	40	138	33	2000		5
TO 200 PV	148335	200	230/12	TA	43	138	35	2500		5
TO 250 PK	146850	250	230/12	TA	35	135	37	2100		5
TO 250 PV	147569R	250	230/12	TA	45	143	33	2400		5
TO 300 PK	148358	300	230/12	TA	50	200	32	3000		5
TO 350 PV	148362	350	230/12	TA	37	180	35	3800		5
TO 350 PK	148362A	350	120/12	TA	37	180	35	3800		5
TO 400 PV	148350A	400	230/12	TA	37	180	35	3800		5
TO 450 PV	149375	450	230/12	TA	38	180	35	3800		5
TO 550 PV	149425	550	230/12	TA	36	190	39	4200		5

* FEV fusibile esterno da montare su primario (attenersi al valore del fusibile indicato sull'etichetta del trasformatore).

Add the FEV protection, externally assembled (see fuse value on the transformer label).

Norme di riferimento
Reference Norms:
EN 61558-1
EN 61558-2-6

Tensione Voltage
230 V - 12 V
230 V - 12/9 V
240 V - 12 V
120 V - 12 V

Frequenza Frequency
0/50...60 Hz

Potenza Power
35 ÷ 550 VA

- Trasformatori da incorporare IP00.
- Classe termica di isolamento B = 120°C.
- A richiesta disponibile versione 240 o 120 V.**
- A richiesta disponibile versione 24 V o altre.**

- IP00 transformers for integrated installation.
- Thermal insulation class B = 120°C.
- 240 or 120 V version available upon request.**
- 24 V version available upon request.**

0,5 - 1,5 □

