

STANDARD CLASSE I

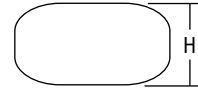

Trasformatori toroidali di sicurezza da incorporare
Safety toroidal transformers for integrated installation

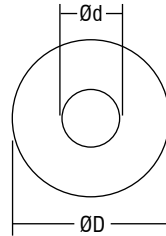

Trasformatori toroidali
Toroidal transformers

| Articolo Article | Codice Code | Potenza Power VA | Tensione Voltage (in/out) V | Protezione Protection | Dimensioni Dimensions | | | Peso Weight gr. | Omologazioni Approvals | Confezioni Box |
|---------------------|----------------|------------------------|-----------------------------------|--------------------------|--------------------------|-----|----|-----------------------|---------------------------|-------------------|
| | | | | | Ød | ØD | H | | | |
| TO 20 I | 146700 | 20 | 230/12 | FEV* | 23 | 72 | 26 | 440 | | 5 |
| TO 20 SV/U | 147010 | 20 | 120/12 | FEV* | 22 | 60 | 40 | 400 | | 5 |
| TO 20 LI.VF | 147110 | 20 | 230/12 | FEV* | 23 | 68 | 31 | 440 | | 5 |
| TO 20 LV | 147120 | 20 | 230/12 | PTC | 23 | 68 | 31 | 440 | | 5 |
| TO 20 LK | 149220 | 20 | 230/12 | TA | 23 | 68 | 31 | 440 | | 5 |
| TO 20 V/U | 147020 | 20 | 120/12 | FEV* | 23 | 68 | 31 | 440 | | 5 |
| TO 35 K | 149070 | 35 | 230/12 | TA | 25 | 75 | 32 | 550 | | 5 |
| TO 40 K | 148080 | 40 | 230/12 | TA | 28 | 82 | 32 | 720 | | 5 |
| TO 50 SI.VF | 147330 | 50 | 230/12 | FEV* | 23 | 68 | 45 | 700 | | 5 |
| TO 50 SV | 147150 | 50 | 230/12 | PTC | 23 | 68 | 45 | 700 | | 5 |
| TO 50 SV/U | 147030 | 50 | 120/12 | FEV* | 23 | 68 | 45 | 700 | | 5 |
| TO 50 TK | 148383S | 50 | 230/12 | TA | 27 | 78 | 35 | 700 | | 5 |
| TO 50 TR | 147935 | 50 | 230/12 | TA | 23 | 78 | 30 | 690 | | 5 |
| TO 50 TR (cl. F) | 147908A | 50 | 240/12 | TA | 23 | 78 | 30 | 690 | | 5 |
| TO 50 LI/VF | 147340 | 50 | 230/12 | FEV* | 28 | 82 | 32 | 720 | | 5 |
| TO 50 LI/TF | 147340F | 50 | 230/12 | TF | 28 | 82 | 32 | 720 | | 5 |
| TO 50 LV | 147160 | 50 | 230/12 | PTC | 28 | 82 | 32 | 720 | | 5 |
| TO 50 LK | 149230 | 50 | 230/12 | TA | 28 | 82 | 32 | 720 | | 5 |
| TO 50 V/U | 147040 | 50 | 120/12 | FEV* | 28 | 82 | 32 | 720 | | 5 |
| TO 50 DAI | 147510 | 50 | 230/12 | FEV* | 28 | 82 | 32 | 750 | | 5 |
| TO 50 DAV | 147520 | 50 | 230/12 | TA | 28 | 82 | 32 | 750 | | 5 |
| TO 50 DAV/U | 147050 | 50 | 120/12 | FEV* | 28 | 82 | 32 | 750 | | 5 |
| TO 60 I.VF | 147350 | 60 | 230/12 | FEV* | 40 | 88 | 32 | 800 | | 5 |
| TO 60 K | 149240 | 60 | 230/12 | TA | 40 | 88 | 32 | 800 | | 5 |
| TO 60 KV | 147170 | 60 | 230/12 | PTC | 40 | 88 | 32 | 800 | | 5 |
| TO 60 V/U | 147060 | 60 | 120/12 | FEV* | 40 | 88 | 32 | 800 | | 5 |
| TO 60 SI.VF | 147064 | 60 | 230/12 | FEV* | 28 | 82 | 32 | 800 | | 5 |
| TO 60 SK | 147064A | 60 | 230/12 | TA | 28 | 82 | 32 | 800 | | 5 |
| TO 60 SV | 147064B | 60 | 230/12 | PTC | 28 | 82 | 32 | 800 | | 5 |
| TO 60 K | 149241 | 60 | 240/12 | PTC | 28 | 82 | 32 | 800 | | 5 |
| TO 70 (cl. F) | 149058 | 70 | 240/12 | TF | 30 | 72 | 50 | 800 | | 5 |
| TO 80 SK | 148183 | 80 | 230/12 | TA | 28 | 70 | 54 | 850 | | 5 |
| TO 80 K | 148180 | 80 | 230/12 | TA | 30 | 90 | 39 | 990 | | 5 |
| TO 80 VF | 148185 | 80 | 230/12 | FEV* | 30 | 90 | 39 | 990 | | 5 |
| TO 100 SK | 147186A | 100 | 230/12 | TA | 32 | 80 | 52 | 1150 | | 5 |
| TO 100 I.VF | 147360 | 100 | 230/12 | FEV* | 35 | 96 | 39 | 1130 | | 5 |
| TO 100 V | 147180 | 100 | 230/12 | PTC | 35 | 96 | 39 | 1130 | | 5 |
| TO 100 V/U | 147070 | 100 | 120/12 | FEV* | 35 | 96 | 39 | 1200 | | 5 |
| TO 105 K | 147940 | 105 | 230/12 | TA | 38 | 98 | 40 | 1250 | | 5 |
| TO 120 K | 147945 | 120 | 230/12 | TA | 38 | 98 | 40 | 1250 | | 5 |
| TO 150 K | 147720N | 150 | 230/12 | TA | 30 | 80 | 67 | 1350 | | 5 |
| TO 150 LI | 147728S | 150 | 230/12 | FEV* | 33 | 100 | 50 | 1350 | | 5 |

Trasformatori toroidali di sicurezza da incorporare Safety toroidal transformers for integrated installation

Norme di riferimento
Reference Norms:
EN 61558-1
EN 61558-2-6

Tensione Voltage
230 V - 12 V
240 V - 12 V
120 V - 12 V

Frequenza Frequency
0/50...60 Hz

Potenza Power
20 ÷ 750 VA

- Trasformatori da incorporare IP00.
 - Classe termica di isolamento B = 120°C.
- A richiesta disponibile versione 240 V.**
A richiesta disponibile versione 24 V o altre.

- IP00 transformers for integrated installation.
 - Thermal insulation class B = 120°C.
- 240 V version available upon request.**
24 V version available upon request.

0,5 - 1,5 □

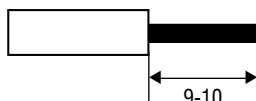

| Articolo Article | Codice Code | Potenza Power VA | Tensione Voltage (in/out) V | Protezione Protection | Dimensioni Dimensions | | | Peso Weight gr. | Omologazioni Approvals | Confezioni Box |
|---------------------|----------------|------------------------|-----------------------------------|--------------------------|--------------------------|-----|----|-----------------------|---------------------------|-------------------|
| | | | | | Ød | ØD | H | | | |
| TO 150 I.VF | 147370 | 150 | 230/12 | FEV* | 35 | 98 | 45 | 1250 | | 5 |
| TO 150 V | 147190 | 150 | 230/12 | TA | 35 | 98 | 45 | 1500 | | 5 |
| TO 150 | 147191 | 150 | 240/12 | TA | 35 | 98 | 45 | 1500 | | 5 |
| TO 150 V/U | 147080 | 150 | 120/12 | FEV* | 35 | 98 | 45 | 1500 | | 5 |
| TO 160 SI | 147303S | 160 | 230/12 | FEV* | 35 | 90 | 50 | 1550 | | 5 |
| TO 160 K | 147216 | 160 | 230/12 | TA | 35 | 98 | 45 | 1550 | | 5 |
| TO 160 LK | 147667S | 160 | 240/12 | TA | 32 | 115 | 40 | 1550 | | 5 |
| TO 180 | 147376 | 180 | 230/12 | TA | 45 | 115 | 45 | 1990 | | 5 |
| TO 200 SK | 147740N | 200 | 230/12 | TA | 39 | 99 | 63 | 2000 | | 5 |
| TO 200 LI | 147729S | 200 | 230/12 | FEV* | 40 | 108 | 53 | 2000 | | 5 |
| TO 200 | 147380 | 200 | 230/12 | FEV* | 45 | 115 | 45 | 1990 | | 5 |
| TO 200 V | 147200 | 200 | 230/12 | TA | 45 | 115 | 45 | 1990 | | 5 |
| TO 200 V/U | 147090 | 200 | 120/12 | FEV* | 45 | 115 | 45 | 1990 | | 5 |
| TO 210 | 147215 | 210 | 230/12 | TA | 45 | 115 | 45 | 2000 | | 5 |
| TO 250 K | 148344S | 250 | 230/12 | TA | 44 | 116 | 53 | 2000 | | 5 |
| TO 250 | 147550 | 250 | 230/12 | FEV* | 43 | 118 | 48 | 2100 | | 5 |
| TO 250 V | 147560 | 250 | 230/12 | TA | 43 | 118 | 48 | 2100 | | 5 |
| TO 300 | 147390 | 300 | 230/12 | FEV* | 40 | 130 | 45 | 2800 | | 5 |
| TO 300 V | 147210 | 300 | 230/12 | TA | 40 | 130 | 45 | 2800 | | 5 |
| TO 300 SV/U | 148336 | 300 | 120/12 | FEV* | 37 | 115 | 55 | 2800 | | 5 |
| TO 300 V/U | 147100 | 300 | 120/12 | FEV* | 40 | 130 | 45 | 2800 | | 5 |
| TO 310 K | 148334 | 310 | 230/12 | TA | 37 | 115 | 55 | 2800 | | 5 |
| TO 350 V | 148070 | 350 | 230/12 | TA | 40 | 132 | 57 | 3600 | | 5 |
| TO 400 | 147400 | 400 | 230/12 | FEV* | 40 | 132 | 57 | 3600 | | 5 |
| TO 400 V | 147220 | 400 | 230/12 | TA | 40 | 132 | 57 | 3600 | | 5 |
| TO 400 V/U | 147960 | 400 | 120/12 | FEV* | 40 | 132 | 57 | 3600 | | 5 |
| TO 500 | 147410 | 500 | 230/12 | FEV* | 40 | 133 | 68 | 4100 | | 5 |
| TO 500 V | 147230 | 500 | 230/12 | TA | 40 | 133 | 68 | 4100 | | 5 |
| TO 500 V/U | 148050 | 500 | 120/12 | FEV* | 40 | 136 | 68 | 4100 | | 5 |
| TO 600 | 148310 | 600 | 230/12 | FEV* | 40 | 136 | 70 | 4100 | | 5 |
| TO 600 K | 148315 | 600 | 230/12 | TA | 40 | 136 | 70 | 4100 | | 5 |
| TO 2x300 | 148309 | 600 | 240/12 | TA | 45 | 162 | 57 | 4300 | | 5 |
| TO 750 | 147243 | 750 | 230/12 | FEV* | 45 | 150 | 70 | 6000 | | 5 |
| TO 750 V | 147239 | 750 | 230/12 | TA | 45 | 150 | 70 | 6000 | | 5 |

* FEV fusibile esterno da montare su primario (attenersi al valore del fusibile indicato sull'etichetta del trasformatore).
Add the FEV protection, externally assembled (see fuse value on the transformer label).

STANDARD CLASSE I



Trasformatori toroidali di sicurezza da incorporare
Safety toroidal transformers for integrated installation



20 VA



50 VA



100 VA



150 VA



160 VA



200 VA



400 VA



600 VA

Trasformatori toroidali
Toroidal transformers