

MILANOinTRACK 41/800-1050

Track adapter with built-in LED driver
Adattatore da binario con LED driver incorporato

Made in Italy 

constant
CURRENT

RIPPLE FREE

Pst LM ≤ 1
SVM $\leq 0,4$

ERC    



2kV DIFF. 4kV COMM.  **ACTIVE PFC**  **DIP-SWITCH**  **SEC. SWITCH**  **SAFETY PROTECTIONS**

Rated Voltage
Tensione Nominale
220 ÷ 240 V

Frequency
Frequenza
50-60 Hz

Rated Current
Corrente Nominale
0,22 A

Inrush Current
Corrente di Spunto
5,5 A - 160 μ S

Max. pcs for MCB B16A
50

Output Power
Potenza Uscita
24 ÷ 44,1 W

Output current ripple
 $\leq 3\%$ ⁽¹⁾

| Article Articolo | P out W | V out DC | I out DC | V out max. | ta °C | tc °C | λ max. Power Factor | η max. Efficiency ⁽¹⁾ |
|--|------------|-------------|-------------|---------------|-----------|----------|-----------------------------------|--|
| MILANOinTRACK 41/800-1050 | 33,6 | 30...42 | 800 mA | 59 | -20...+35 | 75 | 0,95 ⁽²⁾ | > 87 % |
| | 37,8 | 30...42 | 900 mA | | | | | |
| | 39,9 | 30...42 | 950 mA | | | | | |
| | 44,1 | 30...42 | 1,05 A | | | | | |

⁽¹⁾ Referred to $V_m = 230$ V, 100% load - Riferito a $V_m = 230$ V, carico 100%

⁽²⁾ Pout > 28 W

| Article Articolo | Code Codice | Color Colore |
|---------------------|----------------|----------------------------|
| 41/800-1050 | 127880W | White - Bianco RAL 9016 |
| 41/800-1050 | 127880G | Grey - Grigio RAL 7040 |
| 41/800-1050 | 127880B | Black - Nero RAL 9005 |

Pcs per box - pezzi per scatola: 20

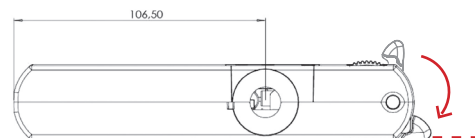

WARNING: During installation do not exceed the limit indicated - Risk of breakage.
ATTENZIONE: in fase di installazione non superare questo limite - Pericolo di rottura.

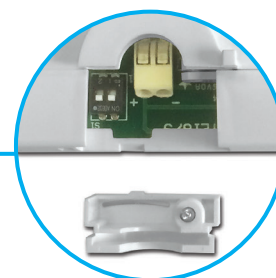
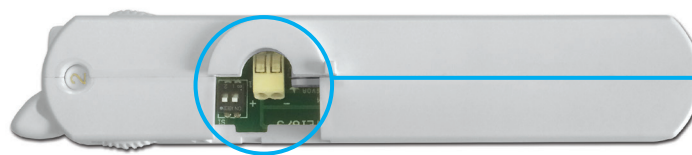
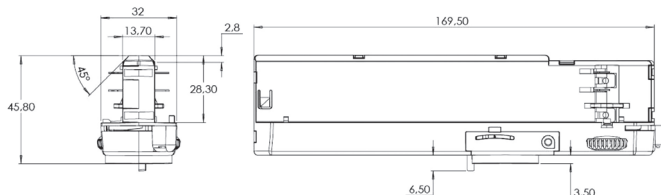

Features

- **Not dimmable driver.**
- A new breakthrough in luminaire design.
- Puts the luminaire design first.
- High power available in a very reduced space.
- Easy to mount through inventive nipple design.
- Compatible with NA Pro and Pulse 3-phase tracks.
- Multipower device supplied with dip-switch for the selection of the output current.
- Active Power Factor Corrector.
- Class II protection against electric shock for direct or indirect contact.
- Current regulation $\pm 5/6\%$ including temperature variations.
- Output push-in terminal blocks: 0,2...0,75 mm².
- Protections:
 - against overheating and short circuits;
 - against mains voltage spikes;
 - against overloads.
- Thermal protection = C.5.a.

Caratteristiche

- **Alimentatore non regolabile.**
- Design all'avanguardia.
- Il design della lampada prima di tutto.
- Elevata potenza disponibile in uno spazio molto ridotto.
- Facile da montare con innovativi attacchi.
- Compatibile con binario NA Pro e Pulse 3-phase.
- Dispositivo multipotenza fornito di dip-switch per la selezione della corrente in uscita.
- PFC attivo.
- Protetto in classe II contro le scosse elettriche per contatti diretti e indiretti.
- Corrente regolata $\pm 5/6\%$ incluse variazioni di temperatura.
- Morsetti di uscita ad innesto rapido: 0,2...0,75 mm².
- Protezioni:
 - termica e cortocircuito;
 - contro le extra-tensioni di rete;
 - contro i sovraccarichi.
- Protezione termica = C.5.a.

7 YEARS WARRANTY
3% FAILURE RATE

10 YEARS WARRANTY
5% FAILURE RATE

PRODUCER'S LIABILITY
TCI

WARRANTY 10 YEARS
ACCORDING TO THE EUROPEAN CONDITIONS