

# MILANOinTRACK 31/550-750



Track adapter with built-in LED driver  
Adattatore da binario con LED driver incorporato

Made in Italy

constant  
**CURRENT**

**RIPPLE FREE**

Pst LM  $\leq 1$   
SVM  $\leq 0,4$



**Rated Voltage**  
Tensione Nominale  
220 ÷ 240 V

**Frequency**  
Frequenza  
50-60 Hz

**Rated Current**  
Corrente Nominale  
0,17 A

**Inrush Current**  
Corrente di Spunto  
5,3 A - 140  $\mu$ S

**Max. pcs for MCB B16A**  
50

**Output Power**  
Potenza Uscita  
16,5 ÷ 31,5 W

**Output current ripple**  
 $\leq 3\%$  <sup>(1)</sup>

Article Articolo	P out W	V out DC	I out DC	V out max.	ta °C	tc °C	$\lambda$ max. Power Factor	$\eta$ max. Efficiency <sup>(1)</sup>
<b>MILANOinTRACK</b> <b>31/550-750</b>	23,1	30...42	550 mA	59	-20...+35	70	0,95 <sup>(2)</sup>	> 87 %
	25,2	30...42	600 mA					
	29,4	30...42	700 mA					
	31,5	30...42	750 mA					

<sup>(1)</sup> Referred to  $V_m = 230$  V, 100% load - Riferito a  $V_m = 230$  V, carico 100%

<sup>(2)</sup> Pout > 22 W

Article Articolo	Code Codice	Color Colore
<b>31/550-750</b>	127879W	White - Bianco RAL 9016
<b>31/550-750</b>	127879G	Grey - Grigio RAL 7040
<b>31/550-750</b>	127879B	Black - Nero RAL 9005

Pcs per box - pezzi per scatola: 20

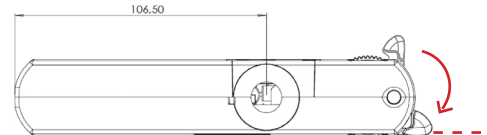

**WARNING:** During installation do not exceed the limit indicated - Risk of breakage.  
**ATTENZIONE:** in fase di installazione non superare questo limite - Pericolo di rottura.

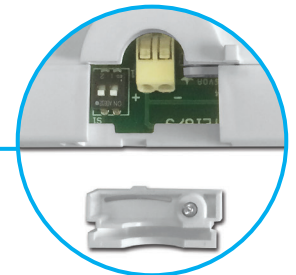
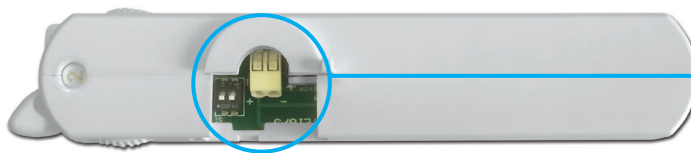
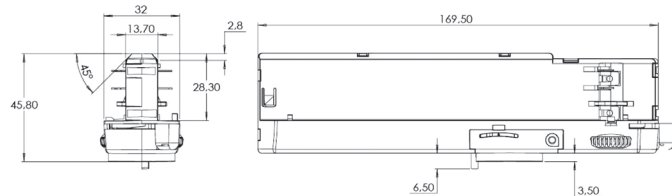

## Features

- **Not dimmable driver.**
- A new breakthrough in luminaire design.
- Puts the luminaire design first.
- High power available in a very reduced space.
- Easy to mount through inventive nipple design.
- Compatible with NA Pro and Pulse 3-phase tracks.
- Multipower device supplied with dip-switch for the selection of the output current.
- Active Power Factor Corrector.
- Class II protection against electric shock for direct or indirect contact.
- Current regulation  $\pm 5/6\%$  including temperature variations.
- Output push-in terminal blocks: 0,2...0,75 mm<sup>2</sup>.
- Protections:
  - against overheating and short circuits;
  - against mains voltage spikes;
  - against overloads.
- Thermal protection = C.5.a.

## Caratteristiche

- **Alimentatore non regolabile.**
- Design all'avanguardia.
- Il design della lampada prima di tutto.
- Elevata potenza disponibile in uno spazio molto ridotto.
- Facile da montare con innovativi attacchi.
- Compatibile con binario NA Pro e Pulse 3-phase.
- Dispositivo multipotenza fornito di dip-switch per la selezione della corrente in uscita.
- PFC attivo.
- Protetto in classe II contro le scosse elettriche per contatti diretti e indiretti.
- Corrente regolata  $\pm 5/6\%$  incluse variazioni di temperatura.
- Morsetti di uscita ad innesto rapido: 0,2...0,75 mm<sup>2</sup>.
- Protezioni:
  - termica e cortocircuito;
  - contro le extra-tensioni di rete;
  - contro i sovraccarichi.
- Protezione termica = C.5.a.

**7 YEARS WARRANTY**  
3% FAILURE RATE

**10 YEARS WARRANTY**  
5% FAILURE RATE

PRODUCER'S LIABILITY  
TCI

10 YEARS WARRANTY TO THE CONTRACTOR'S CONDITIONS

230V LED driver track adapters  
Alimentatore LED 230V per adattatori da binario

10.1